

Recommended PCB Layout  
General Tolerance ±0.05mm

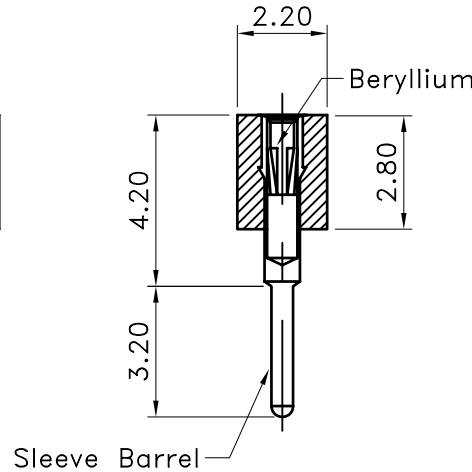
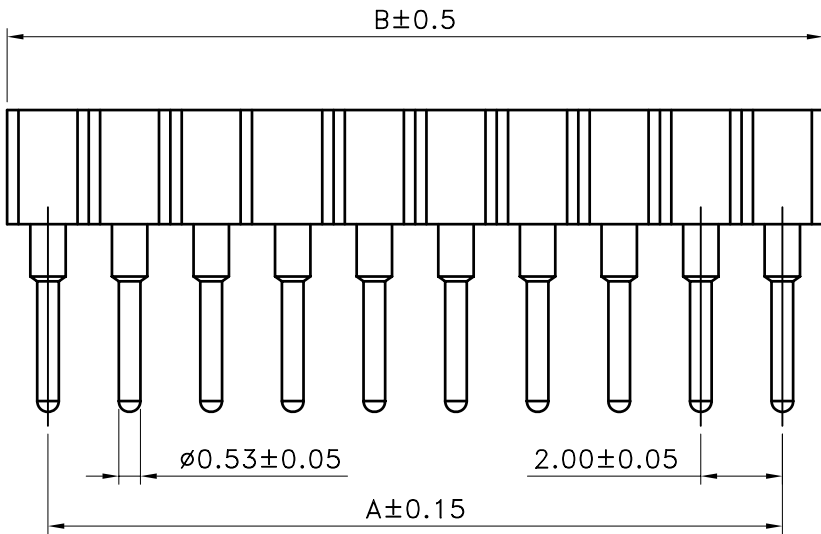

### ■ SPECIFICATIONS

- Voltage Rating : 60V AC/DC
- Current Rating : 3A
- Withstanding Voltage : 1,000V AC /minute
- Insulation Resistance : 1,000MΩ min
- Temperature Range : - 40°C to + 105°C
- Contact Resistance : 10mΩ max

### ■ 2.00MM SIP SOCKET

- Part No. : JS-11801SFTD-XX
- Poles : 2-40(Single Row)
- Material : Beryllium : Copper(BeCu) , Gold Plated  
Sleeve Barrel : Brass , Tin Plated  
Base : PPS UL94V-0
- Q' ty : 1,000 pcs./Bag

| Poles | Dimensions(mm) |       | Poles | Dimensions(mm) |       |
|-------|----------------|-------|-------|----------------|-------|
|       | A              | B     |       | A              | B     |
| 2     | 2.00           | 4.00  | 22    | 42.00          | 44.00 |
| 3     | 4.00           | 6.00  | 23    | 44.00          | 46.00 |
| 4     | 6.00           | 8.00  | 24    | 46.00          | 48.00 |
| 5     | 8.00           | 10.00 | 25    | 48.00          | 50.00 |
| 6     | 10.00          | 12.00 | 26    | 50.00          | 52.00 |
| 7     | 12.00          | 14.00 | 27    | 52.00          | 54.00 |
| 8     | 14.00          | 16.00 | 28    | 54.00          | 56.00 |
| 9     | 16.00          | 18.00 | 29    | 56.00          | 58.00 |
| 10    | 18.00          | 20.00 | 30    | 58.00          | 60.00 |
| 11    | 20.00          | 22.00 | 31    | 60.00          | 62.00 |
| 12    | 22.00          | 24.00 | 32    | 62.00          | 64.00 |
| 13    | 24.00          | 26.00 | 33    | 64.00          | 66.00 |
| 14    | 26.00          | 28.00 | 34    | 66.00          | 68.00 |
| 15    | 28.00          | 30.00 | 35    | 68.00          | 70.00 |
| 16    | 30.00          | 32.00 | 36    | 70.00          | 72.00 |
| 17    | 32.00          | 34.00 | 37    | 72.00          | 74.00 |
| 18    | 34.00          | 36.00 | 38    | 74.00          | 76.00 |
| 19    | 36.00          | 38.00 | 39    | 76.00          | 78.00 |
| 20    | 38.00          | 40.00 | 40    | 78.00          | 80.00 |
| 21    | 40.00          | 42.00 |       |                |       |



喬訊電子工業股份有限公司

CHYAO SHIUNN  
ELECTRONIC INDUSTRIAL LTD.

PART NO JS-11801SFTD-XX  
2.00mm SIP Socket (Single Row)

| APPROVED BY | SCALE      | UNIT    | TOLERANCE  | LTR | REVISION RECORD | NAME | DATE       | LTR | REVISION RECORD                  | NAME | DATE |
|-------------|------------|---------|------------|-----|-----------------|------|------------|-----|----------------------------------|------|------|
| 張育瑞         |            | mm      | .0 ±0.30   | △   | RoHS Compliant  | XXX  | 2007/01/06 | △   |                                  |      |      |
| CHECKED BY  | PROJ       | VER NO. | .00 ±0.20  | △   | 200812-017      | 黃科源  | 2008/12/23 | △   |                                  |      |      |
| 黃科源         |            | a3      | .000 ±0.10 | △   | 修改物性表           | 張逸維  | 2013/04/09 | △   |                                  |      |      |
| DRAWN BY    | DATE       | SIZE    | ANGLE      |     |                 |      |            |     | CUSTOMER                         |      |      |
| 張逸維         | 2013/04/09 | A4      | 0° ±1°     | △   |                 |      |            |     | Conforms to The RoHS Instruction |      |      |
|             |            |         | .0° ±      | △   |                 |      |            |     |                                  |      |      |
|             |            |         | SHEET      | 1/1 | △               |      |            |     |                                  |      |      |